

Pi-filter

33824004S

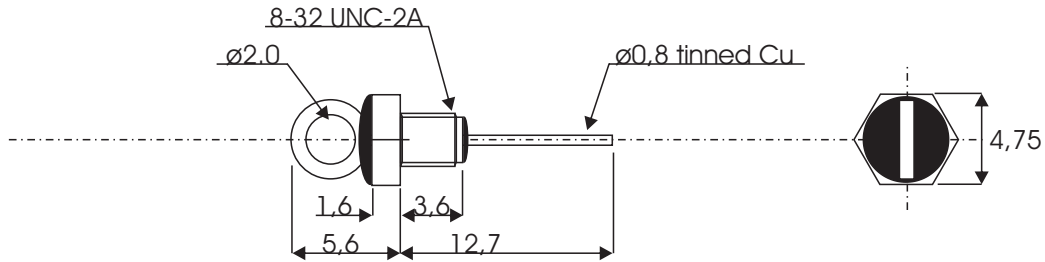

Working voltage.....	100Vdc.
Test voltage.....	250Vdc 1min.
Feed-through current.....	max 5 A.
Insulation resistance.....	min 10^3 MOhm.
IEC category.....	55/125/56
Capacitance.....	min. 2 x 750pF
Inductance.....	min. 100nH
Marking.....	None.

Attenuation (typical values).....	1MHz	2dB
	10MHz	10dB
	100MHz	50dB
	1000MHz	80dB